

Buses orientables

ARROSAJE HAUTE PRESSION

En laiton

KOPAL

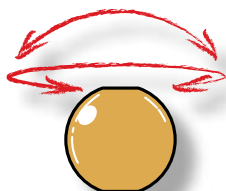

**Buse à trou lisse
Type BB**

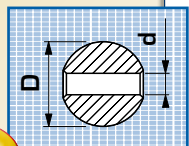
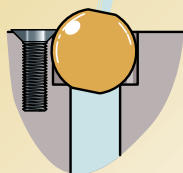

33 bar max

rotule (D)	jet (d)	Réf.
10 mm	2,8 mm	BB1004
10 mm	4 mm	BB1007
11 mm	2,8 mm	BB1014
11 mm	4 mm	BB1015
12 mm	4 mm	BB1024
12 mm	5,5 mm	BB1027
14 mm	4 mm	BB1037
14 mm	5,5 mm	BB1040
15 mm	4 mm	BB1049
15 mm	5,5 mm	BB1052
22 mm	4 mm	BB1071
22 mm	5,5 mm	BB1074
1/2"	4 mm	BB1083
1/2"	5,5 mm	BB1086
5/8"	4 mm	BB1107
5/8"	5,5 mm	BB1110

avec tube
d'extension
page 36

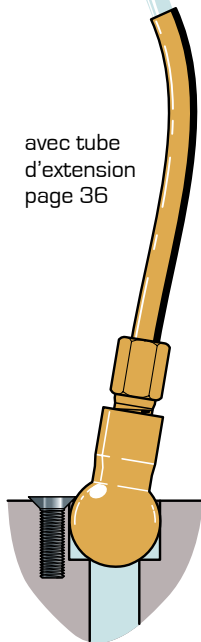

33 bar max

**Buse à trou
tarudé
Type BB**

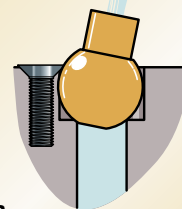
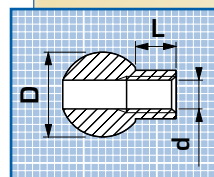

Ø jet (mm)

D	d	L	Réf.
10 mm	M 6	0	BB1001
11 mm	M 5	6	BB1016
12 mm	M 5	6	BB1018
14 mm	M 6	7,9	BB1031
15 mm	M 6	7,9	BB1043
22 mm	M 6	7,9	BB1065
1/2"	M 5	6	BB1077
5/8"	M 6	7,9	BB1101

avec gicleur
page 37

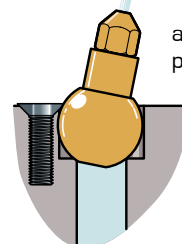

33 bar max

**Buse à trou lisse
jet d'angle
Type BB**

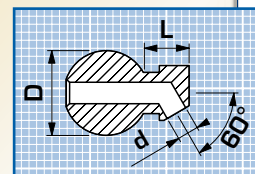
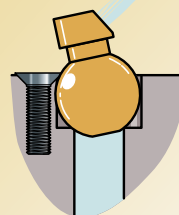

Ø jet (mm)

D	d	L	Réf.
10 mm	2,8	6,35	BB1012
11 mm	4	9,15	BB1017
12 mm	4	9,15	BB1021
14 mm	4	9,15	BB1034
15 mm	4	9,15	BB1046
22 mm	4	9,15	BB1068
1/2"	4	9,15	BB1080
5/8"	4	9,15	BB1104

- Température d'utilisation : 148°C maxi
- Rotule en laiton



Buses à rotules

Rotule à tube en INOX Type SB

100 bar max

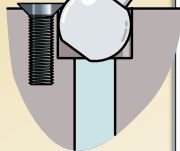
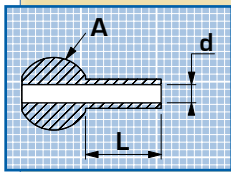

Rotule A	Ø jet (tube) d x L	Réf.
3/8	1,6 x 6,35	SB3310
3/8	1,6 x 31,75	SB3320
3/8	2,2 x 6,35	SB3330
3/8	2,2 x 31,75	SB3340
3/8	3 x 12,7	SB3350
3/8	3 x 31,75	SB3360
3/8	4 x 12,7	SB3370
3/8	4 x 31,75	SB3380
Ø 12 mm	1,6 x 9,65	SB3410
Ø 12 mm	1,6 x 31,75	SB3420
Ø 12 mm	2,2 x 9,65	SB3430
Ø 12 mm	2,2 x 31,75	SB3435
Ø 12 mm	3 x 12,7	SB3440
Ø 12 mm	3 x 31,75	SB3445
Ø 12 mm	4 x 12,7	SB3460
Ø 12 mm	4 x 31,75	SB3465
Ø 12 mm	5,6 x 12,7	SB3470
Ø 12 mm	5,6 x 31,75	SB3475
Ø 15 mm	4 x 19,05	SB3510
Ø 15 mm	4 x 38,1	SB3520
Ø 15 mm	5,6 x 19,05	SB3540
Ø 15 mm	5,6 x 38,1	SB3550
Ø 15 mm	7,1 x 19,05	SB3560
Ø 15 mm	7,1 x 38,1	SB3570

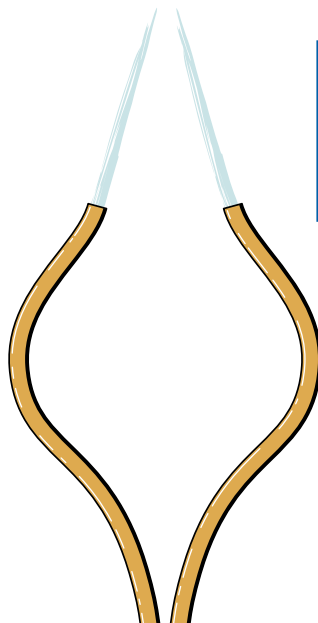

- Rotule en laiton
- Tuyau en cuivre recuit
- Température d'utilisation : 148°C maxi



Rotule à tuyau simple Type LP

Tuyau en cuivre recuit

33 bar max

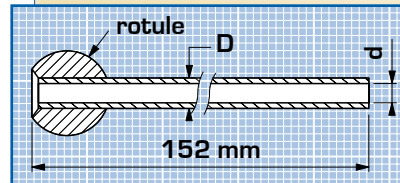
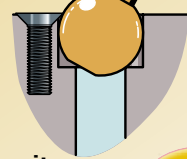

Ø jet (mm)			
Ø rotule	d	tube D	Réf.
9 mm	3	4,7	LP5501
10 mm	3	4,7	LP5502
11 mm	3	4,7	LP5504
12 mm	3	4,7	LP5506
12 mm	4,6	6,35	LP5508
14 mm	3	4,7	LP5510
14 mm	4,6	6,35	LP5512
15 mm	3	4,7	LP5514
15 mm	4,6	6,35	LP5516
18 mm	3	4,7	LP5518
18 mm	4,6	6,35	LP5520
22 mm	3	4,7	LP5522
22 mm	4,6	6,35	LP5524
3/8"	3	4,7	LP5526
1/2"	3	4,7	LP5530
1/2"	4,6	6,35	LP5532
5/8"	3	4,7	LP5534
5/8"	4,6	6,35	LP5536

Rotule à tuyau double Type TP

Tuyaux en cuivre recuit

33 bar max

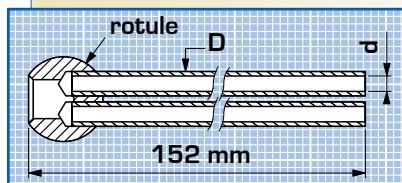

Ø jet (mm)			
Ø rotule	d	tubes D	Réf.
12 mm	3	4,7	TP5815
14 mm	3	4,7	TP5820
15 mm	3	4,7	TP5825
18 mm	3	4,7	TP5827
22 mm	3	4,7	TP5830
1/2"	3	4,7	TP5805
5/8"	3	4,7	TP5810

